

ICR-W401

4G LTE, GPS, IEEE 802.11 b/g/n 2T2R and DI/DO Router



- Multi-band connectivity with FDD LTE/ TDD LTE/ WCDMA/ GSM/ LTE Cat 4
- IEEE 802.11b/g/n WiFi 2T2R
- Enhance security and encryption for authentication and transmission
- -30 ~ 70°C for use in harsh environments
- Compact size



The ICR-W401 is a compact, lightweight and cost-effective Industrial grade 4G LTE Router that has 1 LAN plus 1 WAN Fast Ethernet connection and supports uplink to 2G/3G/4G mobile data networks. Built for harsh environments, the router is equipped with a DI/DO interface. The ICR-W401 is simple to configure through its embedded Web user interface applications. The ICR-W401's WiFi is compliant with IEEE 802.11b/g/n wireless connectivity. The Router features VPN Tunneling with Firewall and management capability via TR069 and SNMP. The ICR-W401 provides highly secure authentication, encryption and management, to protect your data between public and private networks and simplify your complicated solutions for smart city and industrial networking.

Features

- Highly reliable and secure for mission-critical cellular communications
- Compact and lightweight design with 1 LAN and 1 WAN Ethernet interfaces
- Supports multi-band connectivity with FDD LTE/ TDD LTE/ WCDMA/ GSM/ LTE Cat 4
- Provides IEEE 802.11b/g/n WiFi 2T2R
- Micro SIM connector and DI/DO interfaces
- LED indicators for connection and data transmission status
- Industrial temperature rated from -30 ~ 70°C for use in harsh environments
- IPv6/IPv4 dual stack and all applications are IPv6 ready
- Enhance security and encryption for authentication and transmission

Specifications

Standard	IEEE 802.3 10Base-T 10Mbit/s Ethernet IEEE 802.3u 100Base-TX Fast Ethernet IEEE 802.1Q Virtual LANs (VLAN) IEEE 802.3x Flow control for Full Duplex IEEE 802.1p LAN Layer 2 QoS for Traffic Prioritization IEEE 802.1X Port based and MAC based Network Access Control, Authentication	LED Display	1 x Power LED 2 x Ethernet LED for each port (LAN/WAN) 1x LTE LED 1 x Function LED (User define by Web)
LTE Interface	Cellular MobilComm standard: (Please see order information for optional area and band) 4G LTE: FDD-LTE, TDD-LTE 3G: WCDMA 2G: GSM/EDGE GNSS: GPS LTE Data rate: Cat 4, 150Mbps (Down load) 50Mbps (up load) 1 x micro SIM Connector (push-push type)	Power Supply	Power Consumption 7 Watt(Max) Power Input 12/24/48VDC (9.6~60VDC)
WiFi Interface (ICR-W401)	IEEE 802.11b/g/n WiFi Standards Support AP or Station mode 2 x RP-SMA for WiFi Antenna 2T2R 300Mbps wireless operation rate 2.4GHz radio for wireless	Operating Temperature	-30 ~ 70°C
Hardware Interface	1 x Micro SIM Connector (push-push type) 1 x LAN 10/100 Mbps Ethernet port 1 x WAN 10/100 Mbps Ethernet port Reset Button for device reset 1x RS232 for console configuration (TXD/RXD/GND) 1 x DI (Non-Isolated), 1 x DO (Non-Isolated) 2 x SMA connectors for detachable LTE Antenna 2 x RP-SMA for WiFi Antenna 1 x GPS detachable Antenna	Storage Temperature	-40 ~ 85°C
Housing	Rugged metal, Fanless, IP30 protection	Operating Humidity	10 ~ 95% (non-condensing)
Dimensions (D x W x H)	75x 92x 30mm	MTBF	271,952 Hours (MIL-HDBK-217)
Weight	400g	Warranty	5 Years
Installation	DIN Rail mounting, or wall mounting (optional)	Certification	EMC CE (EN55032, EN55035) Radio NCC (ICR-W401-TW) EN62311 RED ETSI EN301 489-1 RED ETSI EN301 489-17 RED ETSI EN301 489-19 RED ETSI EN301 489-52 RED ETSI EN301 511 RED ETSI EN301 908-1 RED ETSI EN301 908-2 RED ETSI EN301 908-13 RED ETSI EN300 328 RED ETSI EN303 413
		Safety	EN62368-1
		Shock	IEC 60068-2-27
		Freefall	IEC 60068-2-32
		Vibration	IEC 60068-2-6

Software Specifications

Network Protocols	IPv4, IPv6, IPv4/IPv6 dual stack, DHCP server and client, PPPoE, Static IP, SNTP, GPS sync time, DNS Proxy, VRRP, OSPF, Message Queue Telemetry Transport (MQTT Broker), BGP	Others	DDNS, QoS, UPnP, SMS action, GPS track Drawing, GPS TCP Push
Routing/Firewall	NAT, Virtual Server, DMZ, MAC Filter, URL Filter, IP Filter, VLAN, Static Routing, RIP 1, RIP 2, IPS, Policy Route	Alarm	DI, DO, SMS, VPN/WAN Disconnect, SNMP Trap, Email, TR069
VPN	OpenVPN, IPSec (3DES, AES128, AES196, AES256, MD5, SHA-1, SHA256), GRE, PPTP, L2TP	Management	Web GUI for remote and local management, CLI Syslog monitor SNMP, TR069 Remote management via SSH v2, HTTPS Local management via Telnet, SSH v2, HTTP/HTTPS
WiFi	Security with WPA2-PSK (AES) Multiple SSID Wireless Mac Filtering Wireless client isolation Wireless Connectivity: WAN WiFi Client		

Application

The vending machine logistics system application

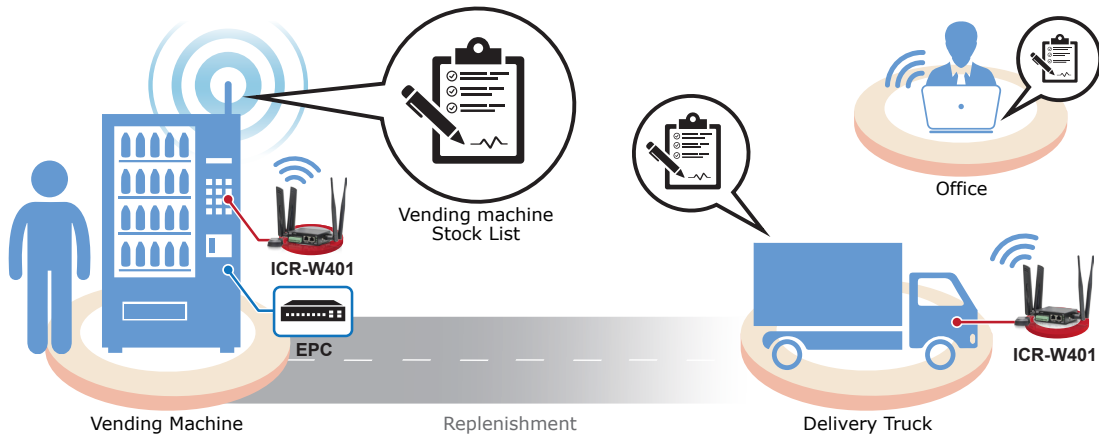

Dimensions

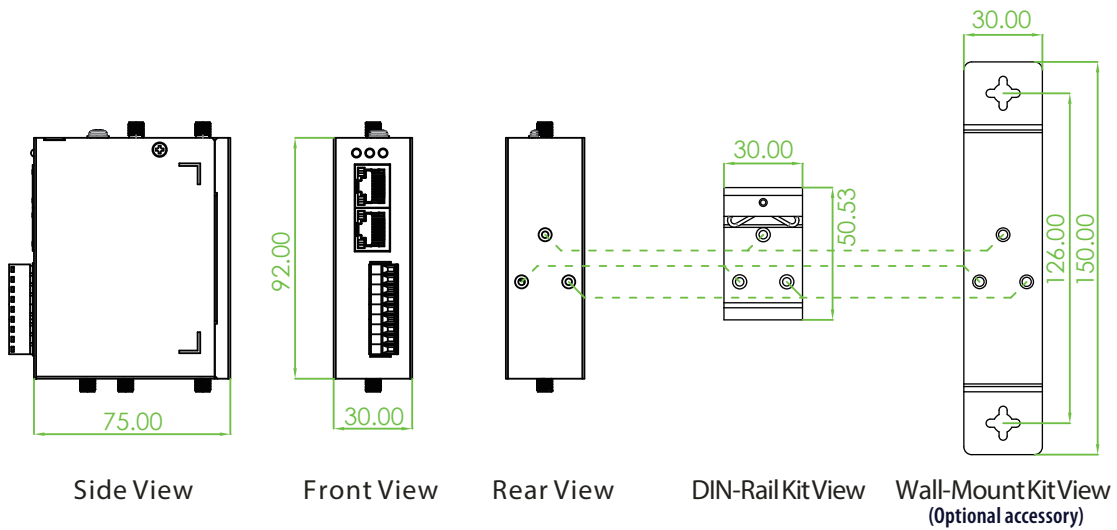

Ordering Information

Model Name	Managed	WAN		LAN			Safety EN62368-1	Certification			
		Cellular Mobile Band	10/100 Base-TX	WiFi IEEE 802.11 b/g/n	10/100 Base-TX	DI/DO		CE	RED	NCC	Shock, Freefall, Vibration
ICR-W401-EU	V	see Region code table-EU	1	1	1	1	V	V	V		V
ICR-W401-A	V	see Region code table-A	1	1	1	1	V	V	V		V
ICR-W401-TW	V	see Region code table-TW	1	1	1	1	V	V	V	V	V

Region Code Table

Region Code	4G LTE		3G	2G	Region
	FDD LTE	TDD LTE	WCDMA	GSM / EDGE	
EU	B1(2100), B3(1800), B5(850), B7(2600), B8(900), B20(800)	B38(2600), B40(2300), B41(2500)	B1(2100), B5(850), B8(900)	B3(1800), B8(900)	Europe, Africa, Middle East, Korea, Thailand, India
A	B2(1900), B4(1700), B12(700)		B2(1900), B4(1700), B5(850)		USA (AT&T, T-Mobile)
TW	B1(2100), B2(1900), B3(1800), B4(1700), B5(850), B7(2600), B8(900), B28(700)	B40(2300)	B1(2100), B2(1900), B5(850), B8(900)	B2(1900), B3(1800), B5(850), B8(900)	ANZ, South America, Taiwan

Optional Accessories

■ Antenna Accessories

ANT-BASE-01	Antennas Base with Magnetic, SMA (Male) connector, 1.5meter for 4G LTE extension
-------------	--



ANT-BASE-01

■ Wall Mount Kit Accessories

IND-WMK03	Wall Mount kit for Industrial product (Compact, 150x 30mm)
-----------	--

■ Industrial Power Supply

MDR-40-48	Industrial Power, Input 85 ~ 264VAC/120 ~ 370VDC, Output 48VDC, 40W, -20 ~ +70°C
-----------	--